

datavideo



PTZ Camera Series

PTC-140/ PTC-140NDI/ PTC-140T





PTZ Camera
PTC-140 SERIES



The PTC-140 series is a cost-effective SDI/HDMI PTZ camera, which features 1/2.8 inch CMOS sensor, 1920x1080px Full HD resolution 20x optical zoom, 10x digital zoom gives you sharp images no matter where you mount the camera.

The PTC-140's onboard streaming encoder can encode up to 2 simultaneous streams to any cloud service, including Datavideo's dvCloud. It supports H.264 /H.265 video compression and dual stream output. Advanced 2D/3D noise reduction allows you to create high quality images even in low light conditions.

The PTC-140 series comes in various models for different settings. PTC-140 NDI features NDI® | HX, which is the first NDI camera launched by Datavideo, and supports simultaneous NDI® | HX, 3G-SDI, HDMI up to 1080P60 hardware output. PTC-140 works with HDBaseT Technology, which allows you to shoot 1080p video, tally, power, and remote by using only one ethernet cable without a need for IP connection.

PTZ Camera

PTC-140 SERIES



PTC-140
PTC-140NDI
PTC-140T

PTC-140 series feature

Broadcast quality 1/2.8-inch CMOS sensor

Resolution is up to 1920x1080 with a frame rate up to 60fps.



Low Noise CMOS effectively ensures high SNR of camera video

Advanced 2D/3D noise reduction technology is used to further reduce the noise, while ensuring image sharpness.



Multiple Network Protocol

Support RTSP, RTMPS protocols, easy to stream directly to your desired CDN streaming platform.



Control thru many ways

Control real-time pan, tilt, and zoom camera movements with Datavideo RMC-300A, 300C, and 180.



Dark blue and white color models

PTC-140 is available in two colors, dark blue and white. Suitable for broadcast, worship, video conferencing and etc.



Tally Light

Tally lights show the preview and program status.



Supports H.264/H.265 video compression

Support compression of resolution up to 1920x1080 with frame up to 60fps and 2 channel 1920x1080p with 30fps compression. AAC, MP3 and PCM audio compression also supported.



RS-232/RS-422/RS-485 Camera Control

RS-232, RS-422 and RS-485 ports to use DVIP and VISCA commands to integrate with larger control systems.



PTC-140NDI feature

One Ethernet cable with NDI® | HX technology

There is no need for multiple cables and complicated setup. Single-wire concept helps you to transfer video, audio, power, tally, and control over only one Ethernet cable.

NDI® | HX

Video Audio Power Tally Control

Control thru many ways

Control real-time pan, tilt, and zoom camera movements with Datavideo RMC-300A, 300C, and 180, as well as, the NDI controller, which supports configurable preset positions.



NDI® Virtual Input

Present PTC-140NDI as the video input source to video streaming applications Skype, GoToMeeting, WebEx, Zoom, and more.



Power over Ethernet

Power Over Ethernet (PoE) functionality allows you to transmit all the information and power over only one cable.

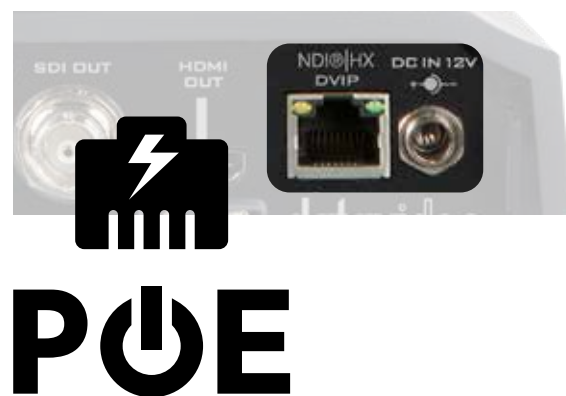

PTC-140T feature

Made with HDBaseT Technology

Instead of using separate cables for video, power and camera control, you can transmit all the information over an Ethernet cable.

Uncompressed video
Tally light signal
PoE to camera
Camera control
DVP/VISCA protocol



Control thru many ways

Control real-time pan, tilt, and zoom camera movements with Datavideo HS-1600T MobileCast switcher, RMC-300A, 300C, and 180.

One Ethernet cable with HDBaseT technology

You can mount the camera in various locations without the need for a power outlet. This helps you reduce to the setup time and be more flexible in term of choosing a location for the camera.





PTZ Camera
PTC-140

PTC-140 System Diagram

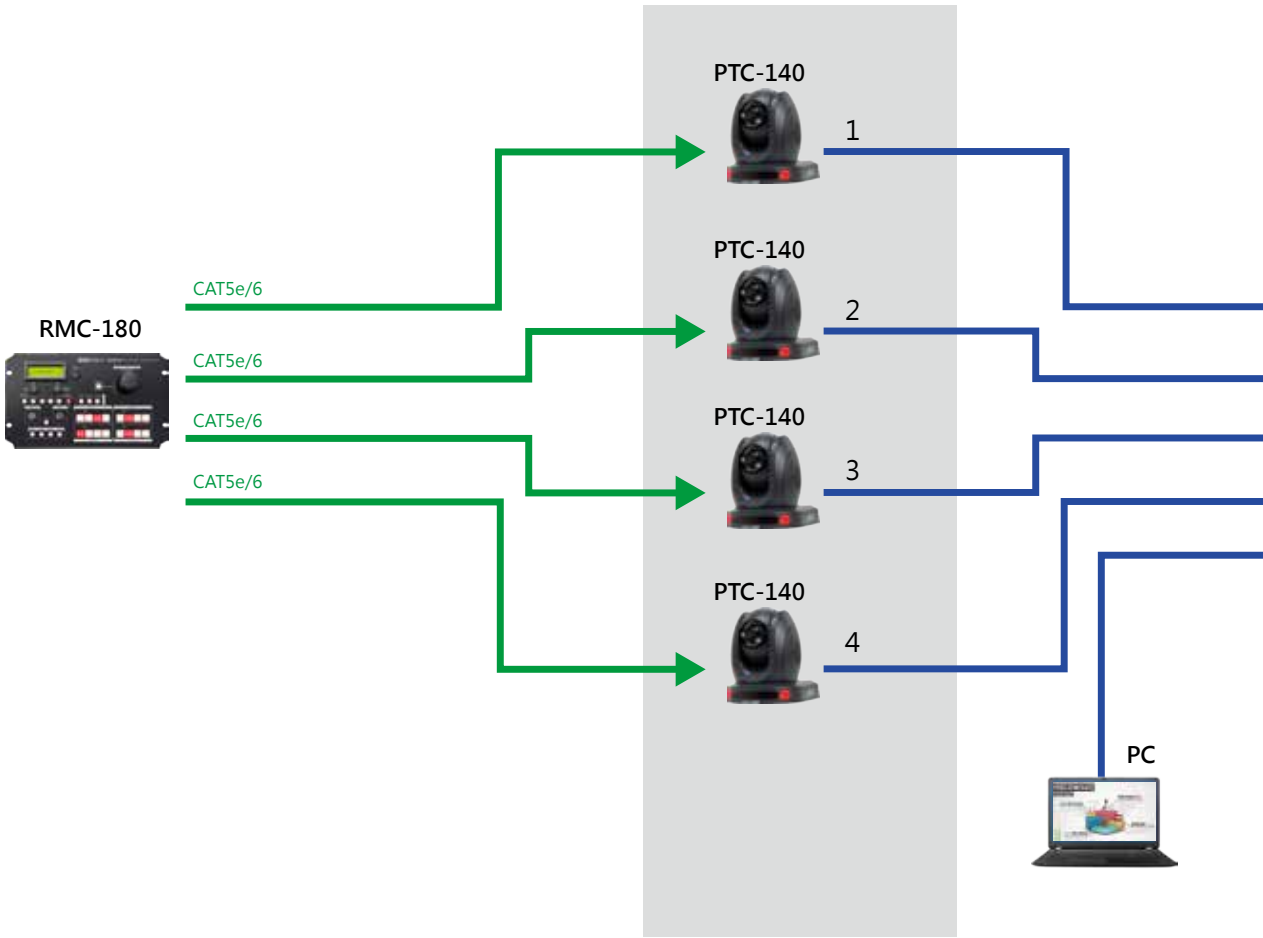

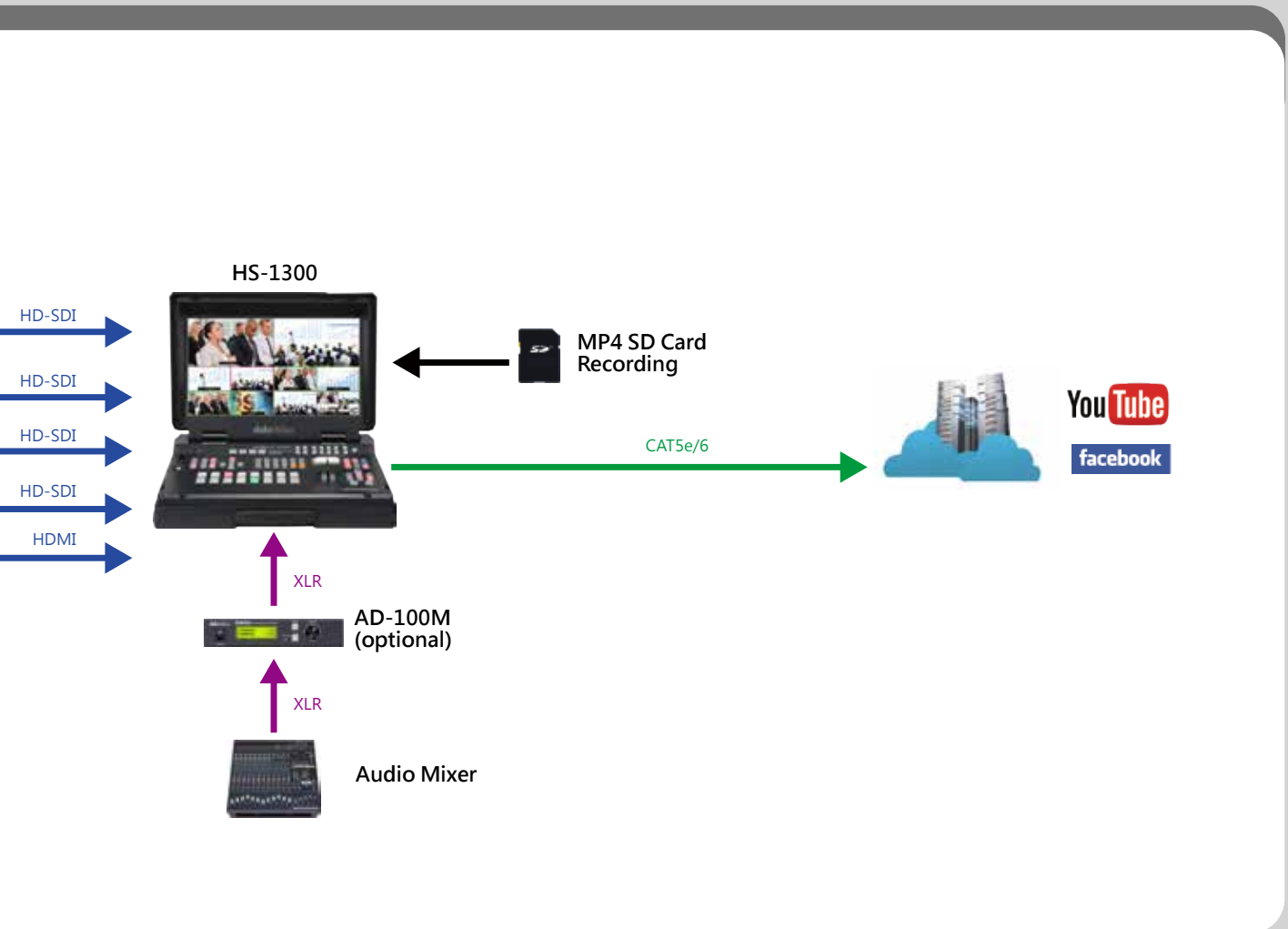



NDI PTZ Camera
PTC-140NDI

PTC-140NDI System Diagram

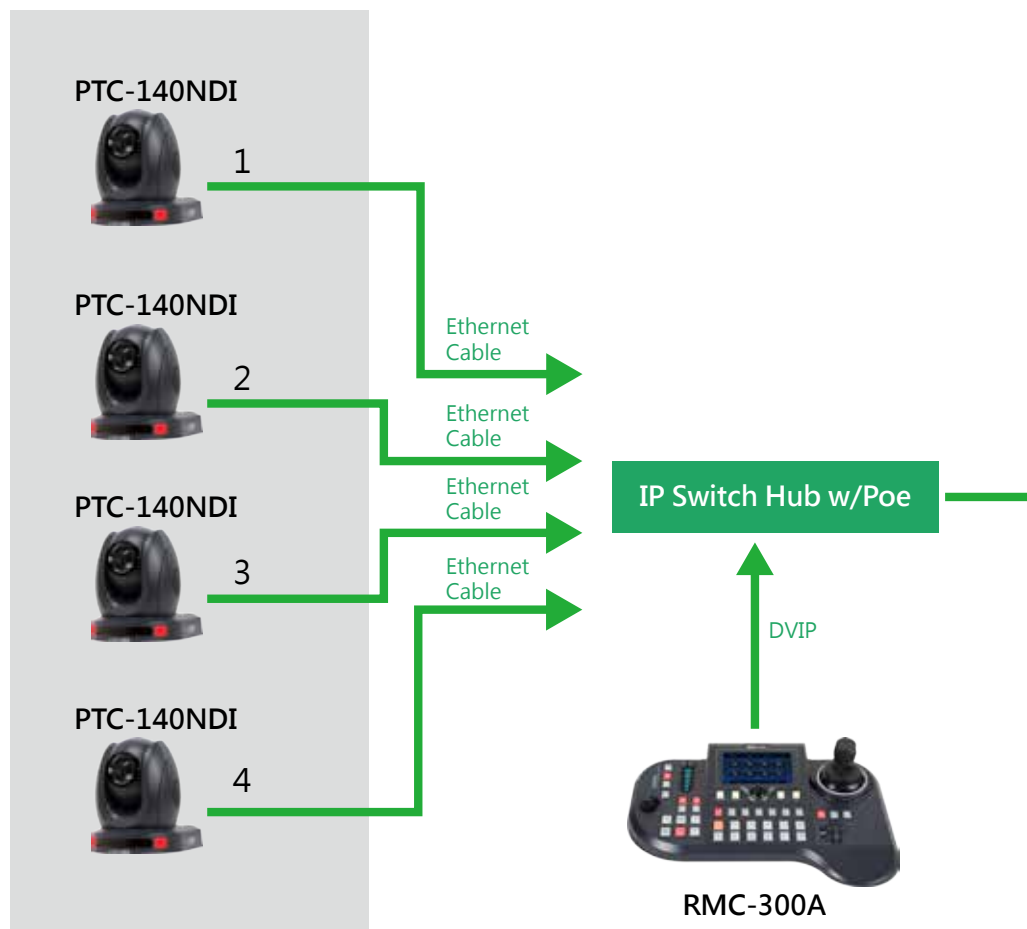

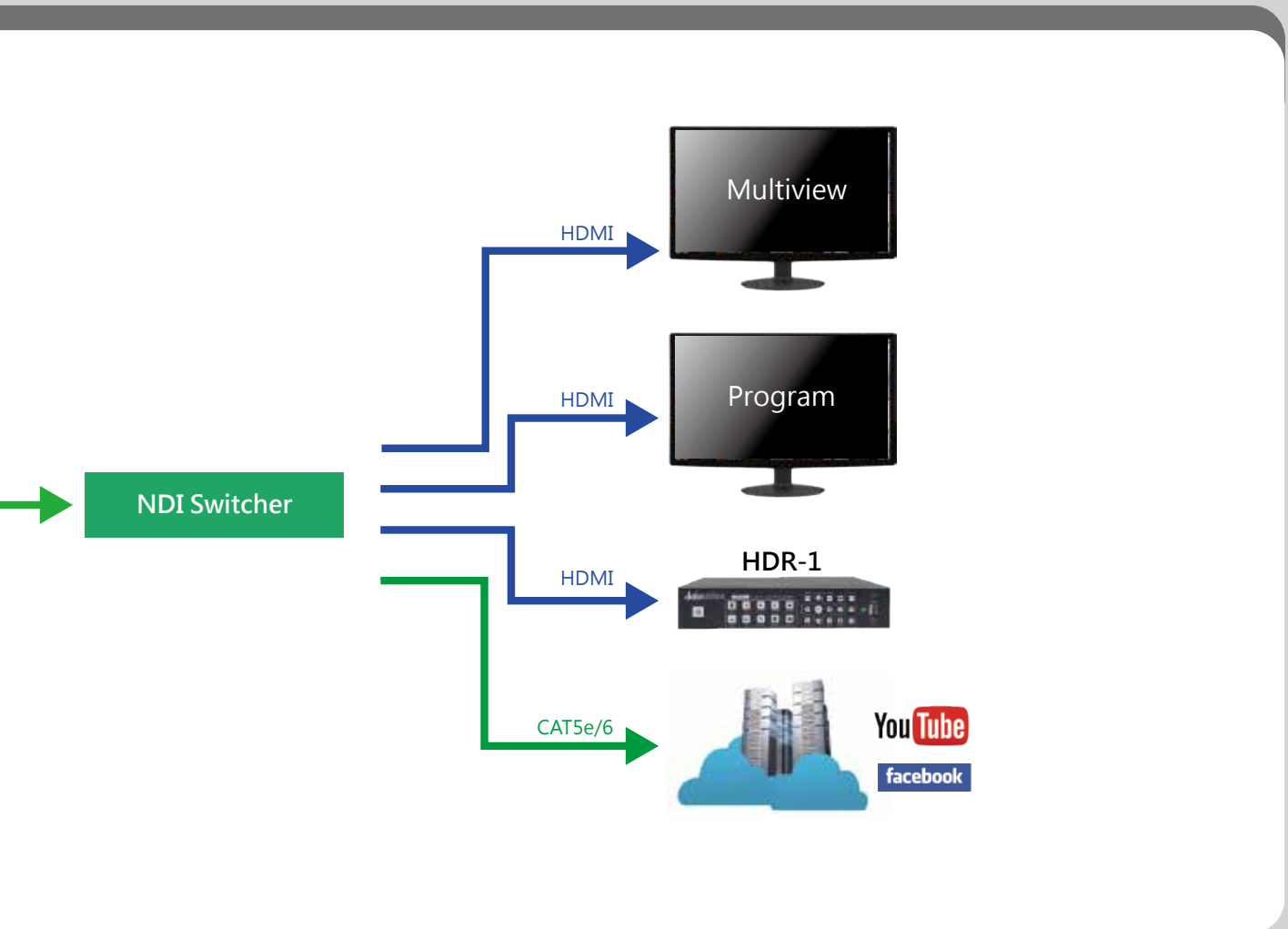



PTC-140T System Diagram

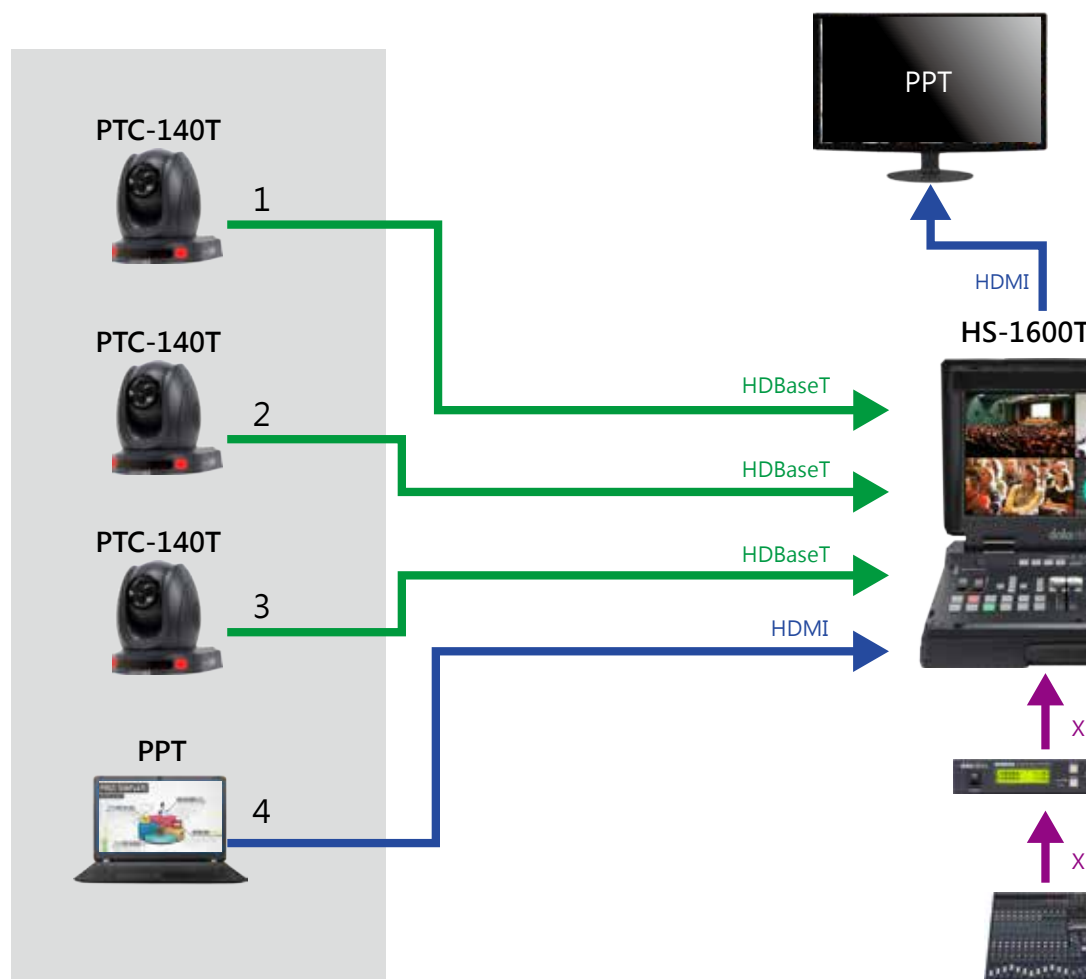

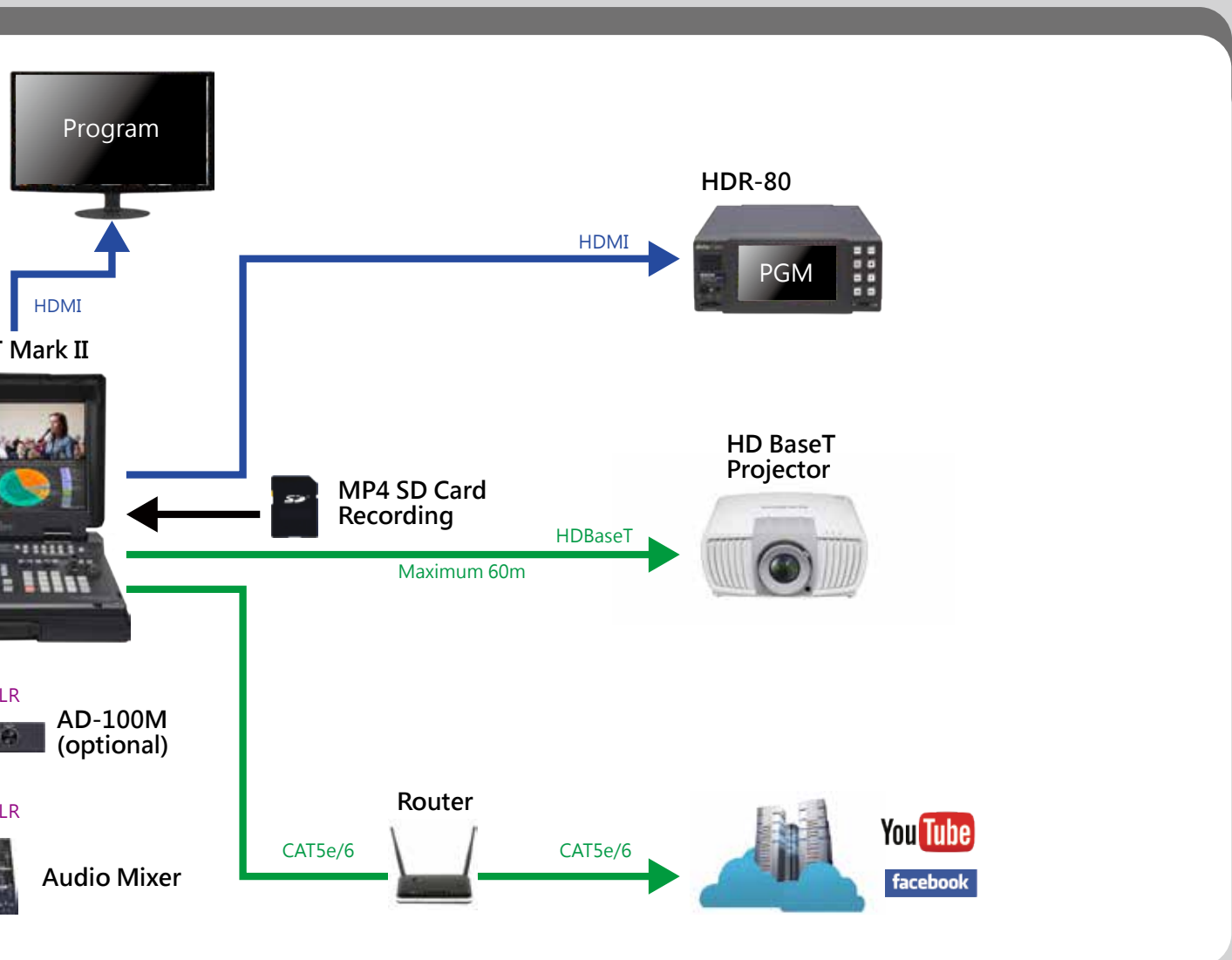

Model Name	PTC-140	PTC-140NDI	PTC-140T
Product Name	HD PTZ Camera	NDI PTZ Camera	HDBaseT PTZ Camera
Video format	1080p 60/59.94/50/30/29.97/25 1080i 60/59.94/50 720p 60/59.94/50	1080p 60/59.94/50/30/29.97/25 1080i 60/59.94/50 720p 60/59.94/50	1080p 60/59.94/50/30/29.97/25 1080i 60/59.94/50 720p 60/59.94/50
Image Sensor	1/2.8 inch high quality HD CMOS sensor	1/2.8 inch high quality HD CMOS sensor	1/2.8 inch high quality HD CMOS sensor
Effective Pixels (approx.)	2.07 Mega pixels	2.07 Mega pixels	2.07 Mega pixels
S/N Ratio	>55dB	>55dB	>55dB
Min. Illumination	0.5Lux (F1.8, AGC ON)	0.5Lux (F1.8, AGC ON)	0.5Lux (F1.8, AGC ON)
Electronic Shutter	Auto / Manual	Auto / Manual	Auto / Manual
Zoom Ratio	20x Optical Zoom, 10x Digital Zoom	20x Optical Zoom, 10x Digital Zoom	20x Optical Zoom, 10x Digital Zoom
Gamma Control	Off / Normal	Off / Normal	Off / Normal
Iris Control	Auto / Manual	Auto / Manual	Auto / Manual
Digital Noise Reductions	Yes	Yes	Yes
On-Screen Display (OSD)	English, Simplified Chinese	English, Simplified Chinese	English, Simplified Chinese
White Balance	Auto, Manual, One Push, 3000K, 4000K, 5000K, 6500K	Auto, Manual, One Push, 3000K, 4000K, 5000K, 6500K	Auto, Manual, One Push, 3000K, 4000K, 5000K, 6500K
AGC / Gain Control	Auto / Manual	Auto / Manual	Auto / Manual
Mirror / Flip Image	Yes	Yes	Yes
Focus Mode	Auto / Manual	Auto / Manual	Auto / Manual
Panning / Tilting Range	Pan: 340° , Tilt: +90° to -30°	Pan: 340° , Tilt: +90° to -30°	Pan: 340° , Tilt: +90° to -30°
Panning / Tilting Speed	Pan: 0.1~60°/sec Tilt: 0.1~30°/sec	Pan: 0.1~60°/sec Tilt: 0.1~30°/sec	Pan: 0.1~60°/sec Tilt: 0.1~30°/sec
Preset	255 Position	255 Position	255 Position
Focal Length	f=5.2 (wide) to 98 (tele) mm F1.6 to F3.5	f=5.2 (wide) to 98 (tele) mm F1.6 to F3.5	f=5.2 (wide) to 98 (tele) mm F1.6 to F3.5
Field of View (Horizontal, Wide)	Approx. 54.7° (WIDE END) / 3.3° (TELE END)	Approx. 54.7° (WIDE END) / 3.3° (TELE END)	Approx. 54.7° (WIDE END) / 3.3° (TELE END)
Image Compensation	Backlight Compensation	Backlight Compensation	Backlight Compensation
Video Output	HDMI x 1 SDI x 1	HDMI x 1 SDI x 1	HDBaseT (PoE) x1 RJ-45 x1
Audio Input	3.5mm Line in	3.5mm Line in	3.5mm Line in
Tally LED	Dual color (Red, Green)	Dual color (Red, Green)	Dual color (Red, Green)
Lens Filter	M52.0 x 0.75 Thread with UV Protection	M52.0 x 0.75 Thread with UV Protection	M52.0 x 0.75 Thread with UV Protection
Control Protocol	VISCA, Pelco-D, Pelco-P, DVIP	VISCA/Pelco-D/Pelco-P; Baud Rate:115 200/38400/9600/4800/2400bps DVIP, NDI	VISCA, Pelco-D, Pelco-P, DVIP
Remote Control Interface and Transmit Distance	RJ-45: for IP control (DVIP) RS-232: Mini DIN 8-pin (IN / OUT) RS-485	LAN: for IP control (DVIP / NDI) RS-232, RS-422, RS-485	RS-232 Lan (RJ-45) HDBaseT(RJ-45)/Serial control on Receiver Box: Transmit up to 100m
Video Compression Format	H.264, H.265, Dual stream output	H.264, H.265, Dual stream output	H.264, H.265, Dual stream output
Audio Compression Format	AAC/MP3/PCM Audio compression	AAC/MP3/PCM Audio compression	AAC/MP3/PCM Audio compression
HD IP Interface	100M IP port(100BASE-TX); Support DVIP	100M IP port(100BASE-TX); Support DVIP and NDI	100M IP port(100BASE-TX); Support DVIP
Network Protocol	TCP/IP, HTTP, RTSP, RTMP(S), DHCP, Multicast, etc	TCP/IP, HTTP, RTSP, RTMP(S), DHCP, Multicast, NDI etc	TCP/IP, HTTP, RTSP, RTMP(S), DHCP, Multicast, etc
POE	--	IEEE802.3af	--
F/W Update	Ethernet	Ethernet	Ethernet
IR Control	Yes	Yes	Yes
Camera Control Unit	RMC-180/RMC-300C	RMC-180/RMC-300C	HS-1500T/HS-1600T/RMC-180/ RMC-300C
Tripod Mount	1/4-20 UNC	1/4-20 UNC	1/4-20 UNC
Optional Accessories	WM-1/ WM-10	WM-1/ WM-10	WM-1/ WM-10
Color	Dark Blue/White	Dark Blue/White	Dark Blue/White
Dimension (LxWxH)	156 x 184 x 186 mm	156 x 184 x 186 mm	156 x 184 x 186 mm
Weight	1.6 kg	1.6 kg	1.6 kg
Operating Temp. Range	0~40 °C	0~40 °C	0~40 °C
Power	DC 12V 12W	DC 12V 12W	DC 12V 12W



@DatavideoUSA
@DatavideoEMEA
@DatavideoTaiwan

@DatavideoAsia
@DatavideoIndia2016
@Datavideojapan



@Datavideo
@Datavideo_EMEA
@Datavideo_Taiwan



@DatavideoUSA
@DVTWDVCN



@DatavideoUSA
@DatavideoEurope

Disclaimers of Product and Services

This brochure is intended as a guide only. We reserve the right to change specifications and availability without prior notice. While we strive for complete accuracy, be aware that it may contain errors and omissions. Prior to purchase, please check with your local Datavideo office or authorised distributor.

datavideo
www.datavideo.com

Ver.20200909